



**280 W. VALLEY BLVD.**  
RIALTO | CA



# FOR LEASE ±36,900 SF

## INDUSTRIAL PROPERTY



### PROPERTY HIGHLIGHTS

- ±36,900 SF Building
- ±5,000 SF Office
- Bonus Mezzanine
- ±3 Acres
- Concrete Tilt-Up | Built in 1989
- 10 GL Doors (14'x14')
- Skylights
- Sprinklered
- 600 Amps Spec.
- T-8 Lights with Sensors
- Fenced Lot
- Short Term Storage Use
- Access to 10, 60, 210 & 215 Freeways
- Paved Parking & Loading Areas
- Short Term Lease (Month-to-Month, 6-18 Months)
- Show By Appointment

FOR MORE INFORMATION PLEASE CONTACT:

**JOSH BURNEY**  
ASSOCIATE  
P: 909.912.0015 | M: 909.974.8163  
jburney@daumcommercial.com  
CADRE #02193758

**ERIC BURNEY, SIOR**  
EXECUTIVE VICE PRESIDENT  
P: 909.652.9051 | M: 909.560.4856  
eric.burney@daumcommercial.com  
CADRE #00697558

Although all information is furnished regarding for sale, rental or financing is from sources deemed reliable, such information has not been verified and no express representation is made nor is any to be implied as to the accuracy thereof, and it is submitted subject to errors, omissions, changes of price, rental or other conditions, prior sale, lease or financing, or withdrawal without notice.



280

WEST VALLEY BLVD.  
RIALTO | CA

**FOR LEASE**  
INDUSTRIAL PROPERTY

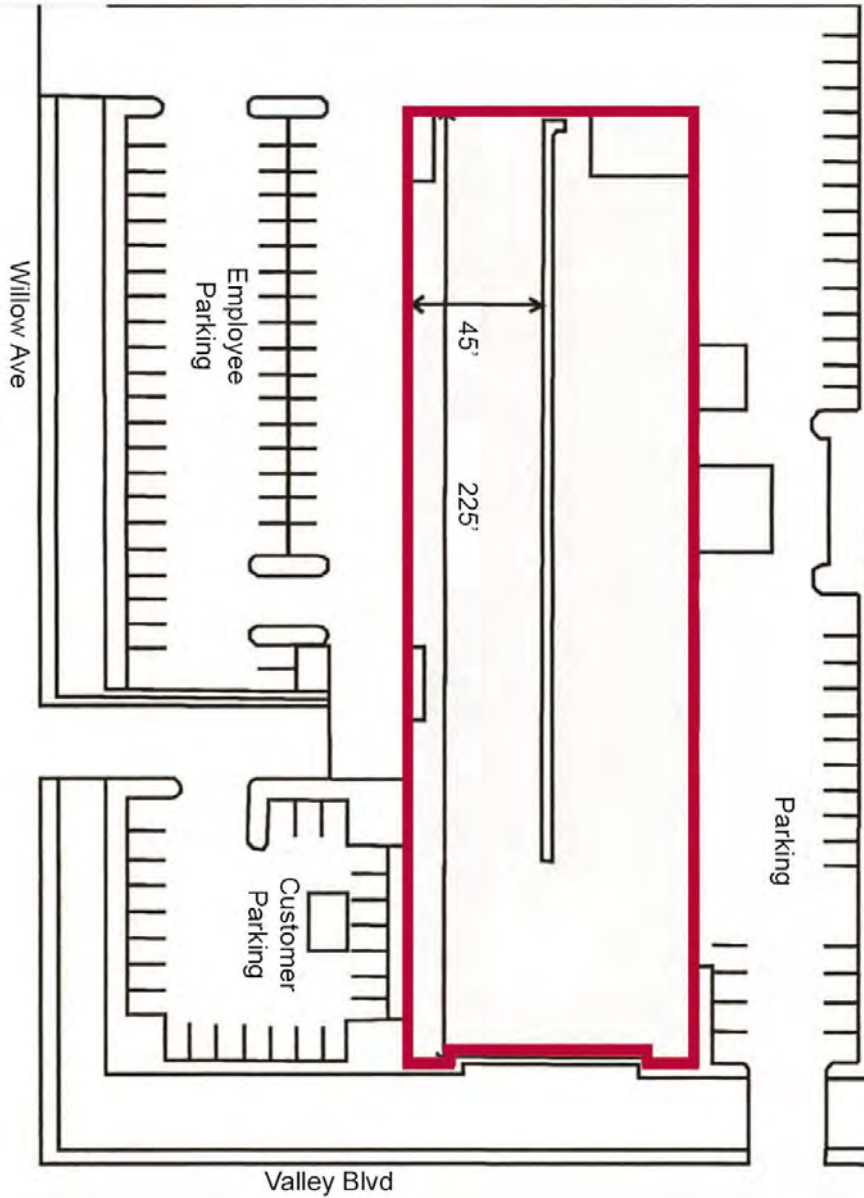

Although all information is furnished regarding for sale, rental or financing is from sources deemed reliable, such information has not been verified and no express representation is made nor is any to be implied as to the accuracy thereof, and it is submitted subject to errors, omissions, changes of price, rental or other conditions, prior sale, lease or financing, or withdrawal without notice.

**DAUM**  
COMMERCIAL REAL ESTATE SERVICES

# 280

WEST VALLEY BLVD.  
RIALTO | CA

# FOR LEASE

INDUSTRIAL PROPERTY



Although all information is furnished regarding for sale, rental or financing is from sources deemed reliable, such information has not been verified and no express representation is made nor is any to be implied as to the accuracy thereof, and it is submitted subject to errors, omissions, changes of price, rental or other conditions, prior sale, lease or financing, or withdrawal without notice.

**DAUM**  
COMMERCIAL REAL ESTATE SERVICES